

## Microbox 125/2DC-B

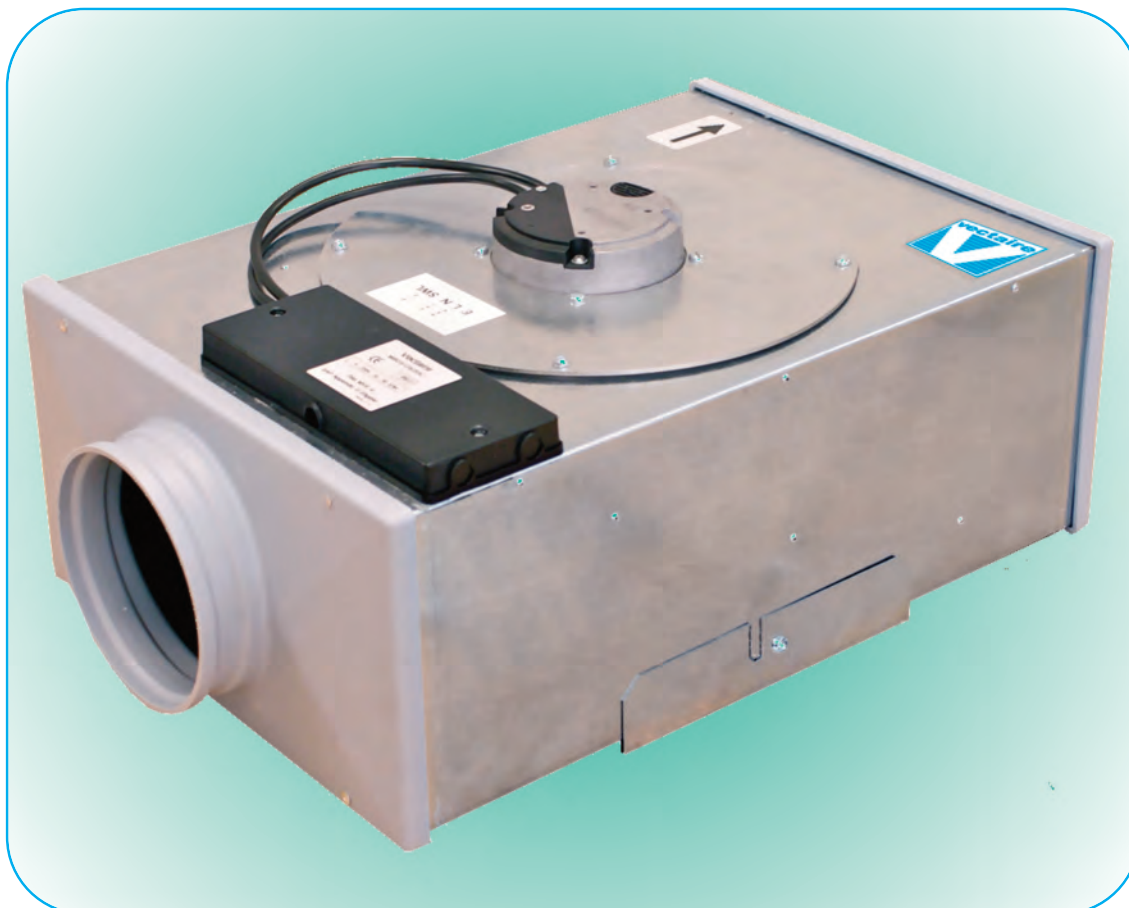

This MEV - MBOX125/2DC-B - is an EST Best Practice Performance Compliant, efficient, low energy solution to controlling condensation and pollution by providing low level continuous ventilation in a kitchen and up to five wet rooms, whilst allowing the user to boost to maximum performance when required.

The MBOX125/2DC-B is generally installed in the loft or roof void and requires only one discharge grille. The noise level and running costs are extremely low and it is compliant with Parts L and F of the Building Regulations.

\* Also available with 204mm x 60mm spigot - MBOX125/2DC204-B

# Microbox 125/2DC-B

## Technical Characteristics



### FEATURES

- **SAP Q eligible** (MEV) whole house mechanical extract ventilation for homes or offices
- continuous ventilation in kitchen and up to 5 additional wet rooms
- maximum airflow 112 l/sec
- suitable for areas up to 270m<sup>2</sup>
- easy to install, commission and maintain
- for fitting into lofts, voids, false ceilings or cupboards (can be angled horizontally or vertically)
- a variable choice of both low (trickle) speed and boost options for optimum setting at installation
- the boost speed can be triggered by a switched live connection from a range of devices:
  - PIRFF (passive infra red)\*
  - DRH240 (dynamic remote humidistat)\*
  - THM (thermostat)\*
  - a light switch (if more than one light switch is used, **each one must be a double pole switch**)
  - a remote switch/pull cord (\*PIRFF, DRH240 and THM may have integral over-run timer which controls the length of time that the fan will continue to operate at its boost speed after the boost has been switched off.)
- very low noise levels
- low running costs
- gives extra security by removing need to open windows
- 3 year warranty
- Vectaire Ltd can supply all accessories for use with these units, including air filter cassettes, silencers, fire dampers, air valves, ducting, outside grilles and wall cowls

### SPECIFICATION

- compact, ultra low profile unit
- casing manufactured from steel lined with acoustic material
- low energy DC external rotor motor has sealed for life bearings
- backward curved blades dynamically balanced
- thermal overload protection
- service and maintenance panel easily accessible
- pre-wired for easy electrical connection
- complete with mounting bracket and anti-vibration plate
- IPX4 rated

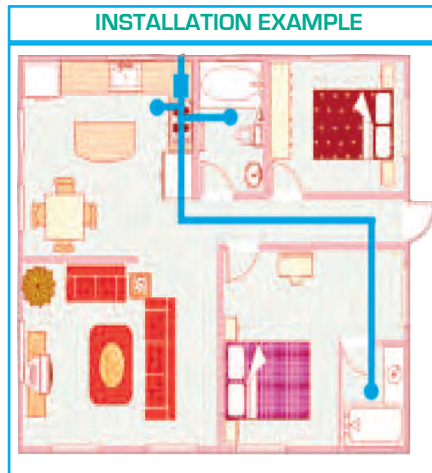

Vectaire Ltd offers a design service to ensure that the unit installed is the best possible to provide efficient, effective, low energy and low running cost ventilation. Vectaire can also organise installation and commissioning of these products

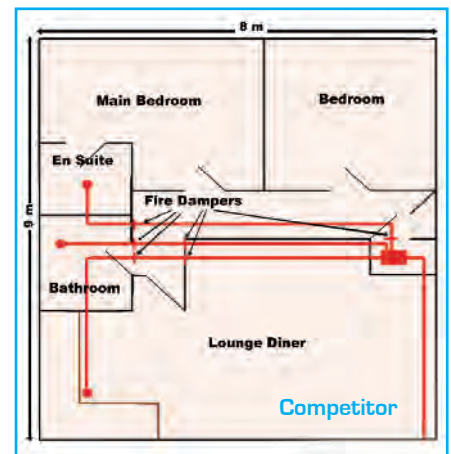
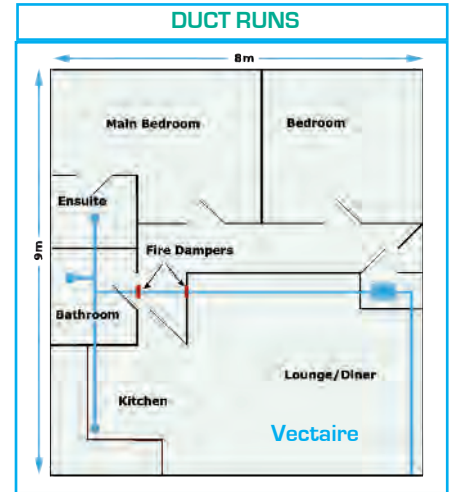

### COMPLIES WITH

- Part L1A and L1B of Building Regulations for enhanced energy saving capability
- Part F of Building Regulations for reliable, efficient ventilation
- complies with IEC 60335-2-80, LVD2006/95/CE and EMC 2004/108/CE European Directive against radio interference and electro-magnetic compatibility
- CE marked
- **SAP Q eligible**
- **Energy Saving Trust Best Practice Compliant**



# Microbox 125/2DC-B

## Technical Characteristics - SAP Results



RESULTS for SAP CALCULATIONS			
ENERGY LEVEL PERFORMANCE - using rigid ducting only			
Exhaust Terminal Configuration	Fan Speed Setting	Specific Fan Power (W/l/s)	EST Best Practice Performance Compliant
Kitchen + 1 additional wet room	100% variable	0.20	Yes
Kitchen + 2 additional wet rooms	100% variable	0.26	Yes
Kitchen + 3 additional wet rooms	100% variable	0.34	Yes
Kitchen + 4 additional wet rooms	100% variable	0.44	Yes
Kitchen + 5 additional wet rooms	100% variable	0.55	Yes

Figures from BRE test results at minimum flow rate conditions

RESULTS for Approved Document F				
Exhaust Terminal Configuration	Fan Speed Setting	Total Flow Rate (l/sec)	Total Flow Rate (wind condition) (l/sec)	% reduction of Total Flow Rate
Kitchen + 1 additional wet room	100% variable	21.0	19.3	8
Kitchen + 2 additional wet rooms	100% variable	29.0	27.9	4
Kitchen + 3 additional wet rooms	100% variable	37.0	36.3	2
Kitchen + 4 additional wet rooms	100% variable	45.0	44.2	2
Kitchen + 5 additional wet rooms	100% variable	53.0	52.5	1

Figures from BRE test results



# Microbox 125/2DC-B

## Technical Characteristics - Performance & Dimensions



curves are for guidance only

